

FOR  
LEASE

# 2126 EDISON AVENUE

SAN LEANDRO, CALIFORNIA

±10,000 SF  
Warehouse /  
Office Space

Available Now



## FEATURES:

- ±10,000 SF
- Private offices
- Kitchenette in the space
- Restrooms
- Warehouse space
- New paint/carpet/lighting in the office area
- New paint/lights in the warehouse
- Two (2) roll up doors
- Parking on site
- Business park setting with deli on site open five days a week
- **\$0.50 PSF, I.G.**

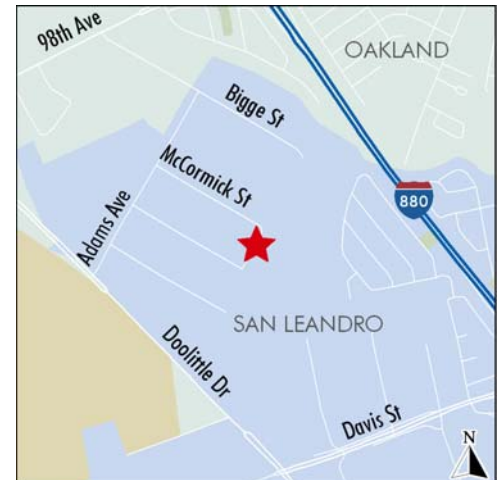

CB Richard Ellis, Inc.  
Broker Lic. 00409987

FOR MORE  
INFORMATION  
PLEASE  
CONTACT

### Michael Barry

Senior Vice President  
Lic. 00950054  
510.874.1926  
michael.barry@cbre.com

### Kenneth Morris

Vice President  
Lic. 01312918  
510.874.1983  
ken.morris@cbre.com

### Mike Conn

Associate  
Lic. 01370833  
510.874.1957  
mike.conn@cbre.com

**CBRE**  
CB RICHARD ELLIS

FOR  
LEASE



# 2126 EDISON AVENUE

SAN LEANDRO, CALIFORNIA

±10,000 SF  
Warehouse /  
Office Space

Available Now



## BUILDING D

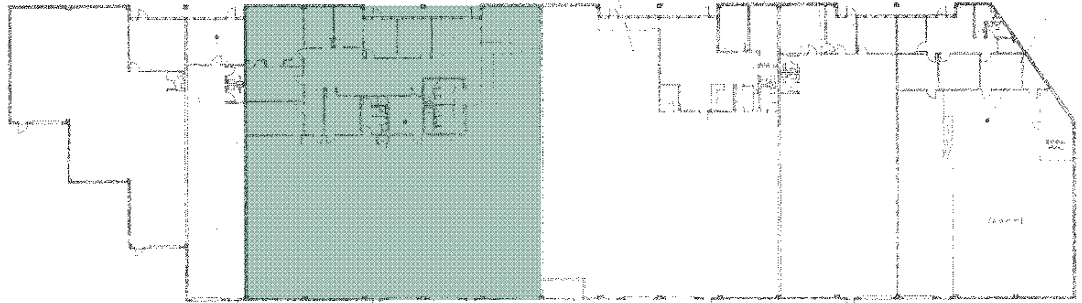

Plan not to scale

CB Richard Ellis, Inc.  
Broker Lic. 00409987

**FOR MORE  
INFORMATION  
PLEASE  
CONTACT**

### Michael Barry

Senior Vice President  
Lic. 00950054  
510.874.1926  
michael.barry@cbre.com

### Kenneth Morris

Vice President  
Lic. 01312918  
510.874.1983  
ken.morris@cbre.com

### Mike Conn

Associate  
Lic. 01370833  
510.874.1957  
mike.conn@cbre.com



CB Richard Ellis | 555 12<sup>th</sup> Street | Suite 900 | Oakland, CA 94607

©2009 CB Richard Ellis, Inc. This information has been obtained from sources believed reliable. We have not verified it and make no guarantee, warranty or representation about it. Any projections, opinions, assumptions or estimates used are for example only and do not represent the current or future performance of the property. You and your advisors should conduct a careful, independent investigation of the property to determine to your satisfaction the suitability of the property for your needs.